

KALDIR SÜR SİSTEM
LIFT & SLIDE SYSTEM

$$KX = \frac{L+20}{2}$$

$$KY = H-72$$

$$G = B+28$$

Not : Cam ölçüleri eşit kabul edilerek formülize edilmiştir.

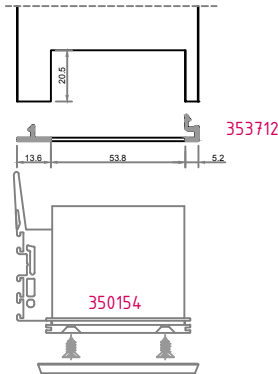
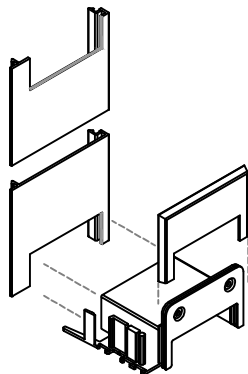
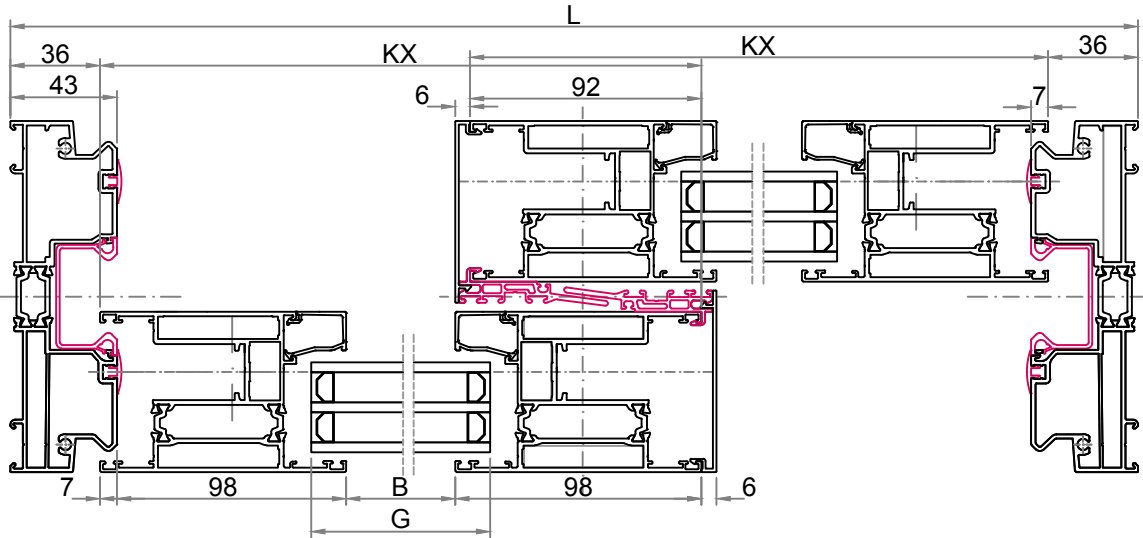
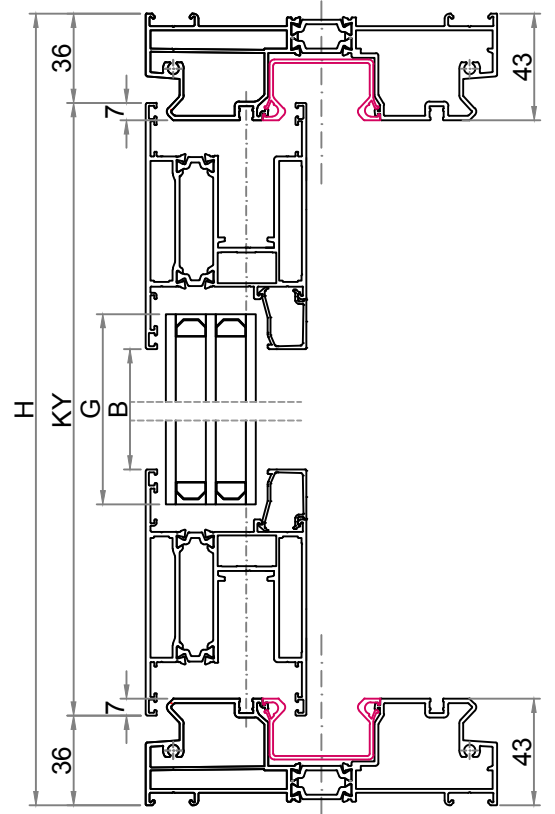

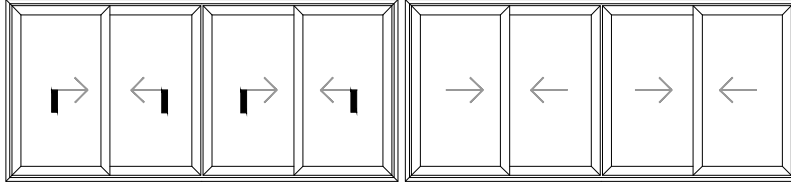

KALDIRI SÜR SİSTEM
LIFT & SLIDE SYSTEM

$$KX = \frac{L+105}{4}$$

$$KY = H - 72$$

$$G = B + 28$$

Not : Cam ölçüleri eşit kabul edilerek formüle edilmiştir.

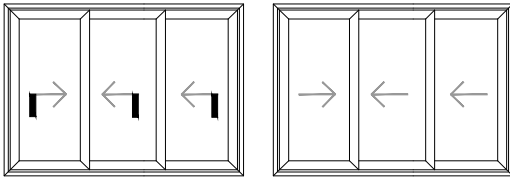
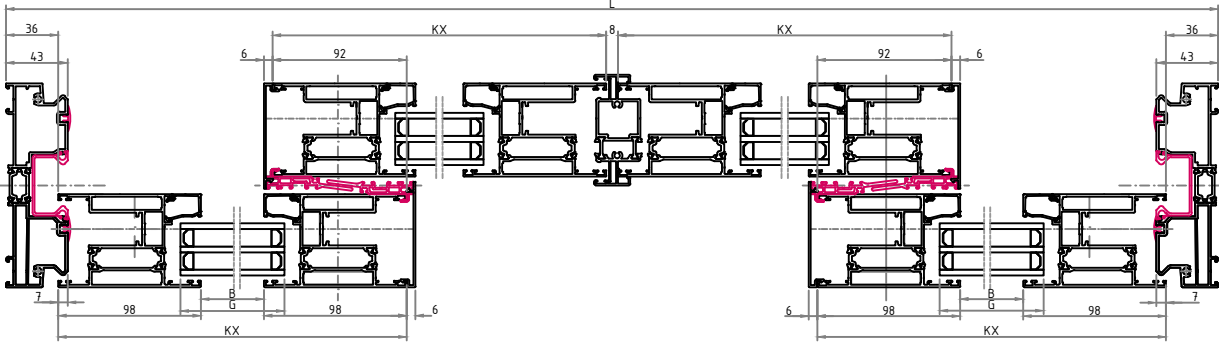
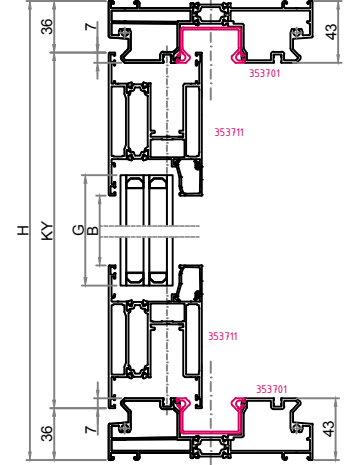

$$KX = \frac{L+113}{3}$$

$$KY = H - 72$$

$$G = B + 28$$

Not : Cam ölçüleri eşit kabul edilerek formüle edilmiştir.

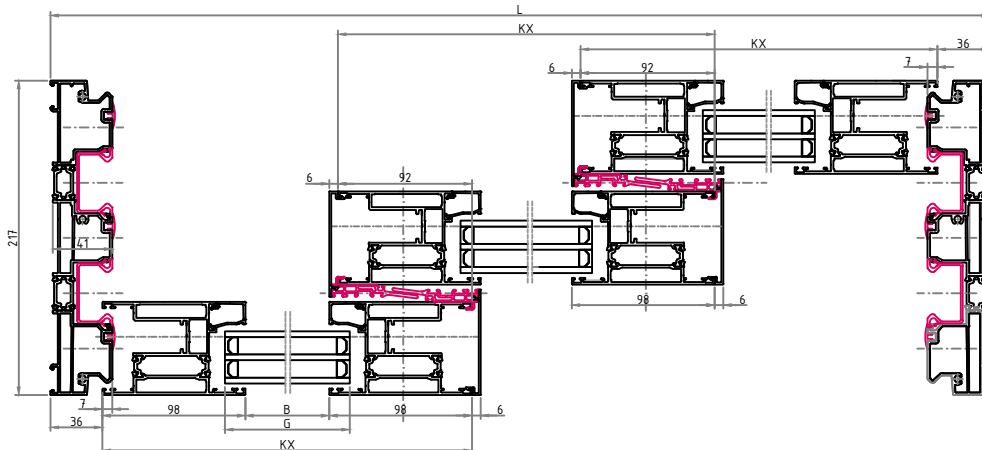
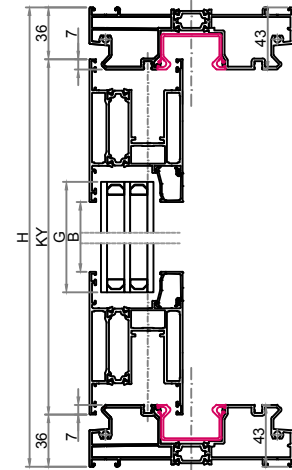

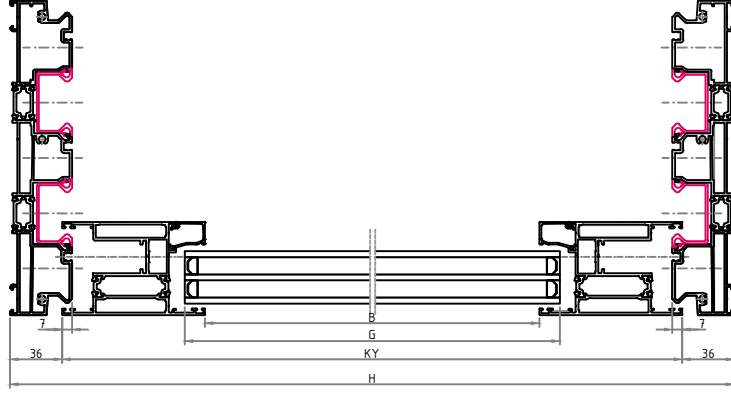

KALDIRI SÜR SİSTEM
LIFT & SLIDE SYSTEM

$KX = \frac{L+290}{6}$
$KY = H-72$
$G = B+28$

Not : Cam ölçüleri eşit kabul edilerek formülize edilmiştir.

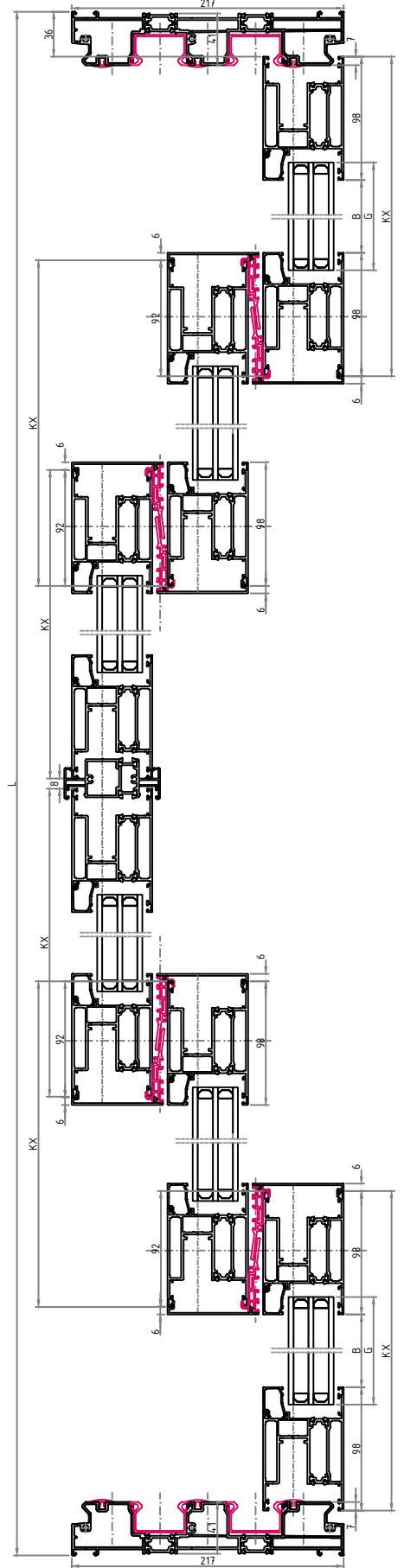
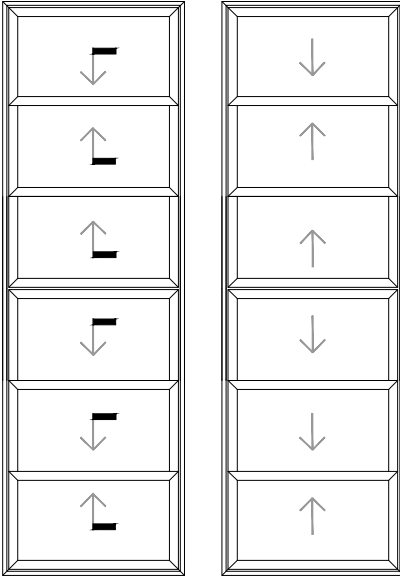

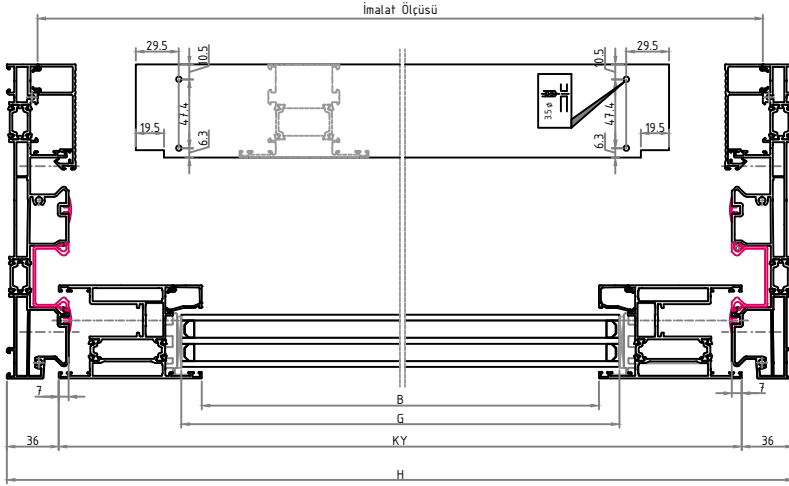

KALDIRI SÜR SİSTEM
LIFT & SLIDE SYSTEM

$KX = \frac{L + 474}{6}$
$KY = H - 72$
$G = B + 28$

Not : Cam ölçüleri eşit kabul edilerek formülize edilmiştir.

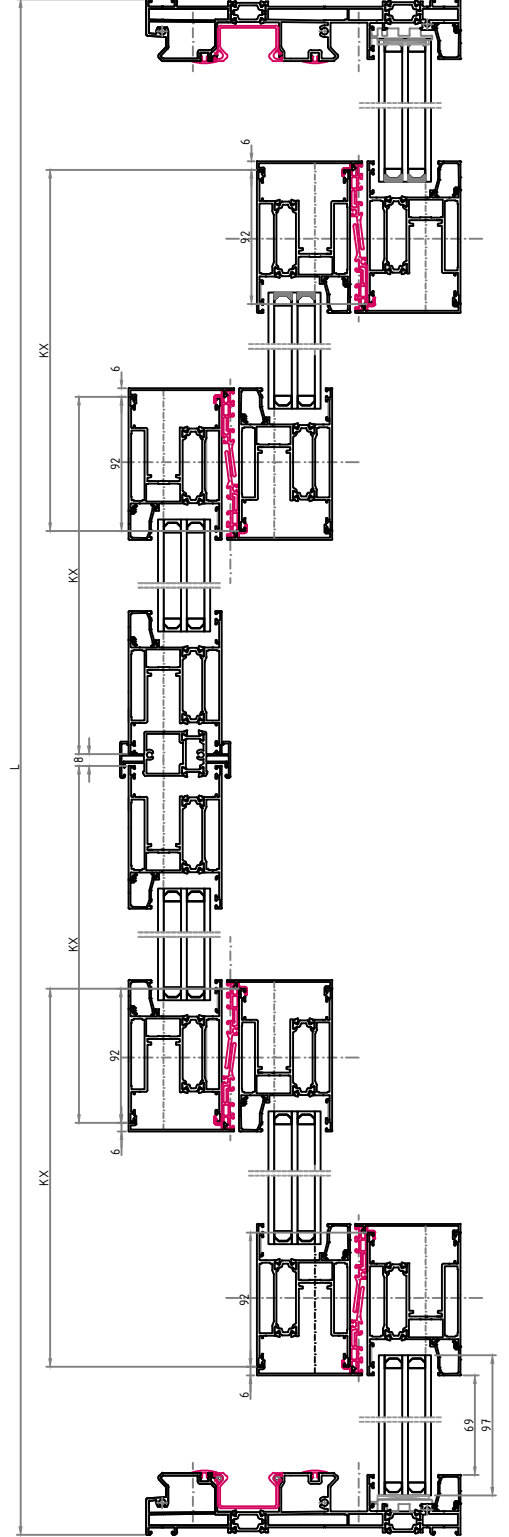
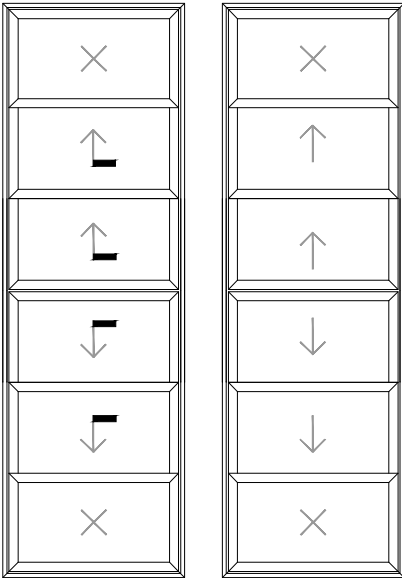

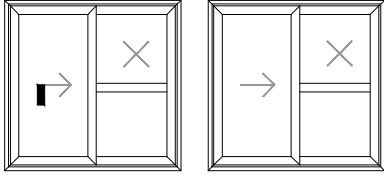

KALDIR SÜR SİSTEM
LIFT & SLIDE SYSTEM

$KX = \frac{L+123}{2}$
$KY = H-72$
$G = B+28$

Not : Cam ölçüleri eşit kabul edilerek formülize edilmiştir.

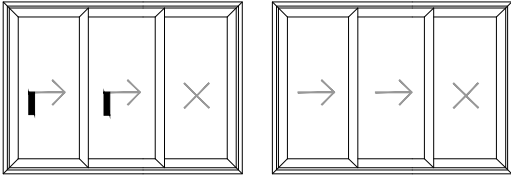
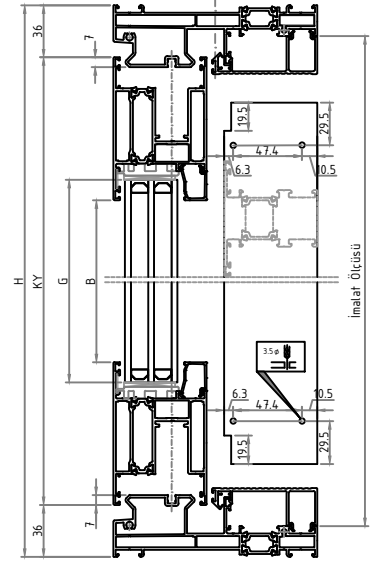
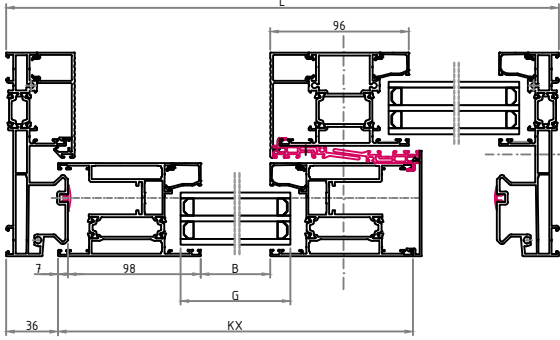

KALDIR SÜR SİSTEM
LIFT & SLIDE SYSTEM

$KX = \frac{L+215}{3}$
$KY = H-72$
$G = B+28$

Not : Cam ölçüleri eşit kabul edilerek formülize edilmiştir.

